



PALOMBA COLLECTION

Freestanding washbasin

DIMENSIONS

Length	525 mm
Width	400 mm
Height	900 mm

COLOUR AND FINISH

000 White

OPTIONS

104 - one tap hole, centre

SPECIFICATION TEXT

Freestanding washbasin LAUFEN PALOMBA COLLECTION, sanitary, ceramic, EN 31, dimensions 525 x 400 mm, asymmetric, 1 tap hole, concealed waste and overflow system, with integrated pedestal, Special feature: Surface refinement LCC (only white), Further options / accessories: without tap hole and with valve without, overflow always open, bathtubs, shower trays, furniture

MOUNTING ACCESSORIES INCLUDED

Charge 104 – waste and overflow system
 Clou, order no. 891941
 Charge 109 – valve without overflow always open, order no. 895439
 Device for fixing M10, order no. 892806
 Installation set: waterinlet hose with valve,
 siphon and extensible pipe D40, order no. 894064
 Base mat, order no. 897804

MOUNTING ACCESSORIES EXCLUDED

Charge 104 – ceramic-plated vertical cover, order no. 898182
 Charge 109 – valve without overflow always open,
 with ceramic valve cover plate, order no. 898184

Asymmetrical

Bowl position : Right

Fixing kit : Included

Installation type : Floor-standing

Internal Shape : 5 - Soft

Material : Vitreous china

Net weight (kg) : 45

Overflow type : Standard

Shape : Soft

Taphole configuration : 1 taphole in the middle

TECHNICAL DRAWINGS

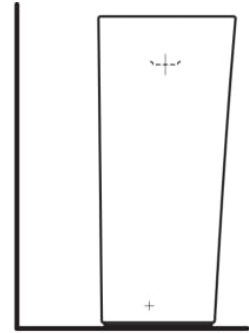
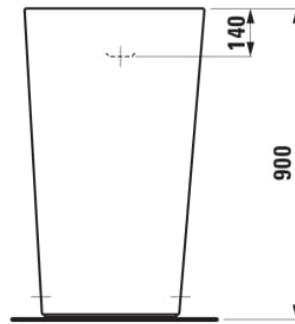
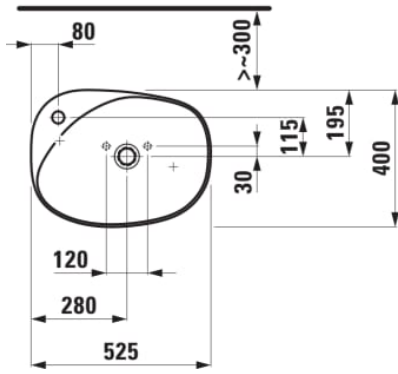

PALOMBA COLLECTION

The design of the LAUFEN PALOMBA COLLECTION recalls small inlets or pebbles shaped by the eternal movement of the sea, expertly transformed into ceramic. All elements of the collection harmonise with one another as each one of them bears the signature of the Italian designer couple, Ludovica+Roberto Palomba.

