

Innhold

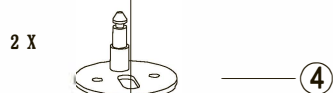

Montering av toalettsete

Vennligst les manualen grundig før montering

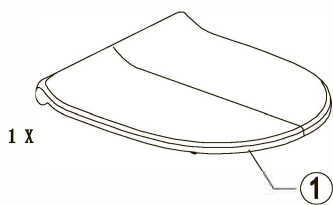

Sett sammen bolter, hengsler og plasser de i toalettets monteringshull.



Løft opp beslaget for å løsne skruene.

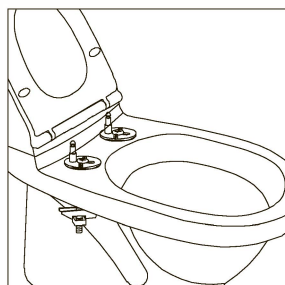

Kontroller at låsebolten sitter riktig og stram forsiktig til. Klikk så på setet og lukk lokket. Juster deretter setet til ønsket posisjon før du fjerner setet igjen.



Stram til boltene forsiktig og kontroller at hengslene sitter korrekt. Fest deretter på dekselheftene og trykk de på plass før setet klikkes på plass.

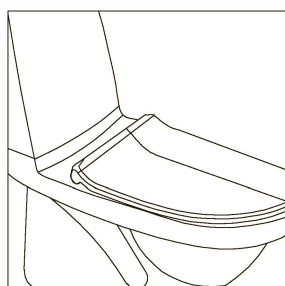

Ditt toalettsete er nå klart til bruk

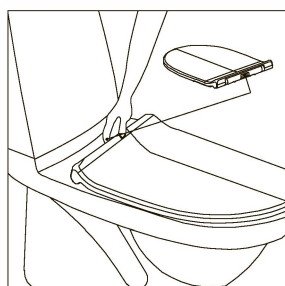

Trykk

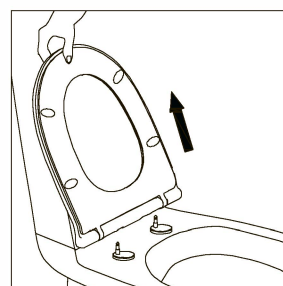

Løft

Content

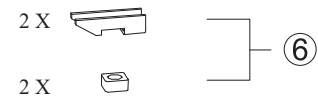
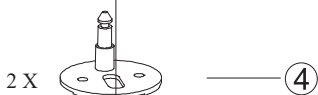
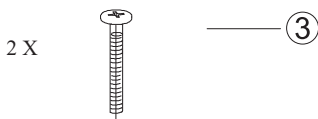
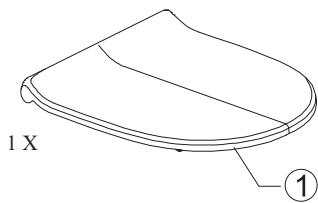

Installing your new Toilet Seat

please read the manual carefully before installing the toilet sest

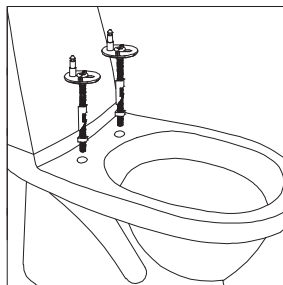

Assemble the bolts and hinges and insert them into the mounting holes in the toilet



lift up the hinge base and tighten the screws loosely with a screwdriver



Position the locking bolt correctly
Click the seat onto the hinges
Close the seat and adjust to desired Position, then open and remove the seat

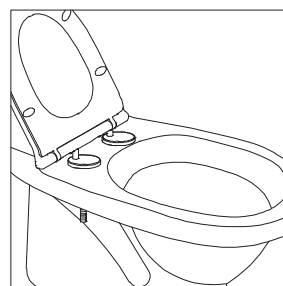

Tighten the bolts firmly and make sure the nut is positioned correctly
Remove the seat and place the cove cap on the hinge base and press in place
Click the seat in on place

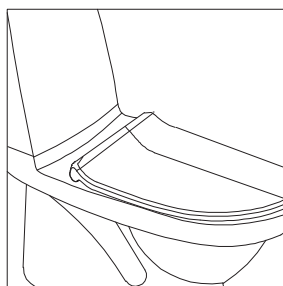

Enjoy your new quality toilet seat

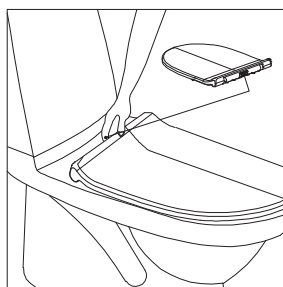

Easy Push

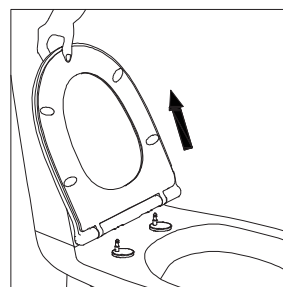

Easy lift