

MERIDIAN

IN-TANK - Wall-hung toilet with integrated tank within the unit. Includes "I" type support, seat and cover. Needs power supply.



DIMENSIONS

Length 400 mm.

Width 595 mm.

Height 400 mm.

COLOURS AND FINISHES

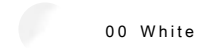

TECHNICAL DRAWINGS

FEATURES

- Fixing kit: Included
- Flushing system: Washdown
- Installation type: Wall-hung
- Outlet type: Horizontal
- Shape: Round

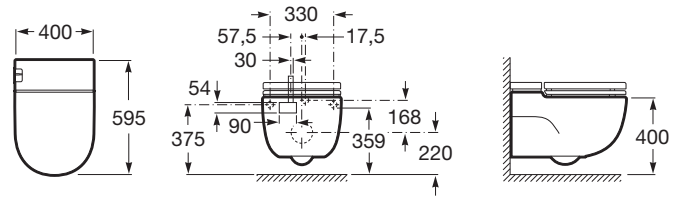



Meridian

One single concept for a thousand solutions. One single concept to fulfil any need. The most versatile and global range.

INSTALLATION AND USER MANUALS

[User handbook](#)

[Installation handbook](#)

[Installation handbook](#)

[Exploded view](#)