

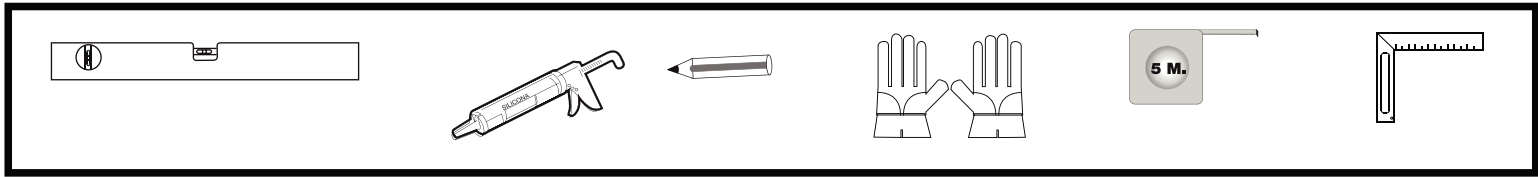

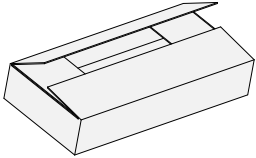







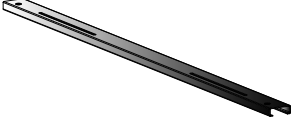

Vitreous Enamel Steel Bathub Front Panels



<p>Descrição do equipamento Description of the equipment</p> 	 x1  x1	
	 x1	 x2  x2  x2  x4  x2  x2



Do not drag the bathtub on the floor.

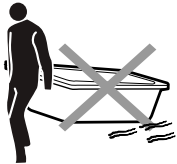

Assistance may be required.

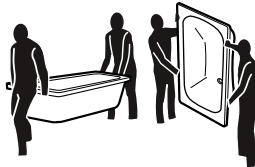

Always remember that you are handling glass



Bathtub metal feet must be installed before starting the panel's assembly.



Before the installation, the panels and bathtub shall be checked for accuracy to size, color, and manufacture defects. Claims in respect to defects which had already existed before the installation cannot be admitted after the installation.



The drain and overflow fittings shall be installed in conformity with the manufacturer's instructions



Dimensional strictness $\pm 5\text{mm}$

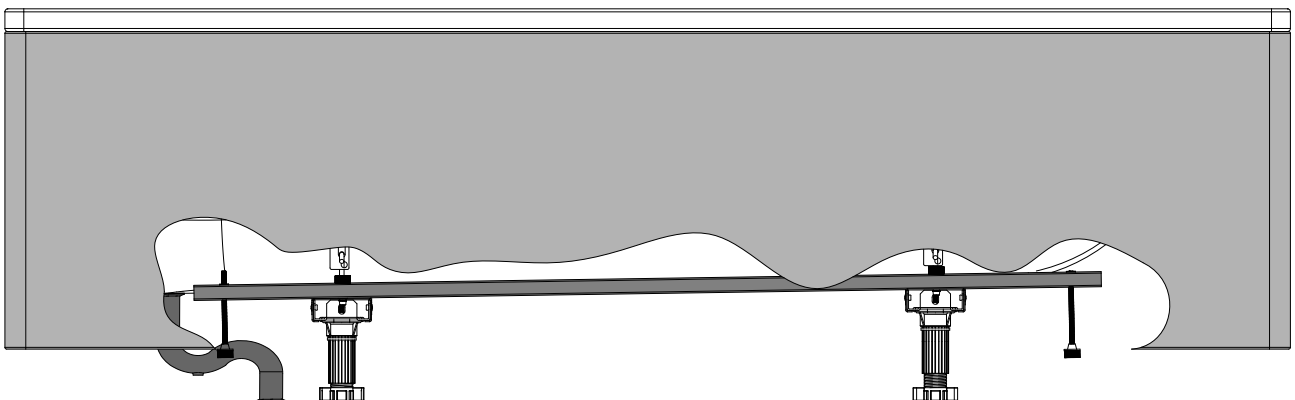

1 Montar os pés da banheira de acordo com as instruções de montagem.
 Assemble the bathtub metal feet according with the attached installation instructions.

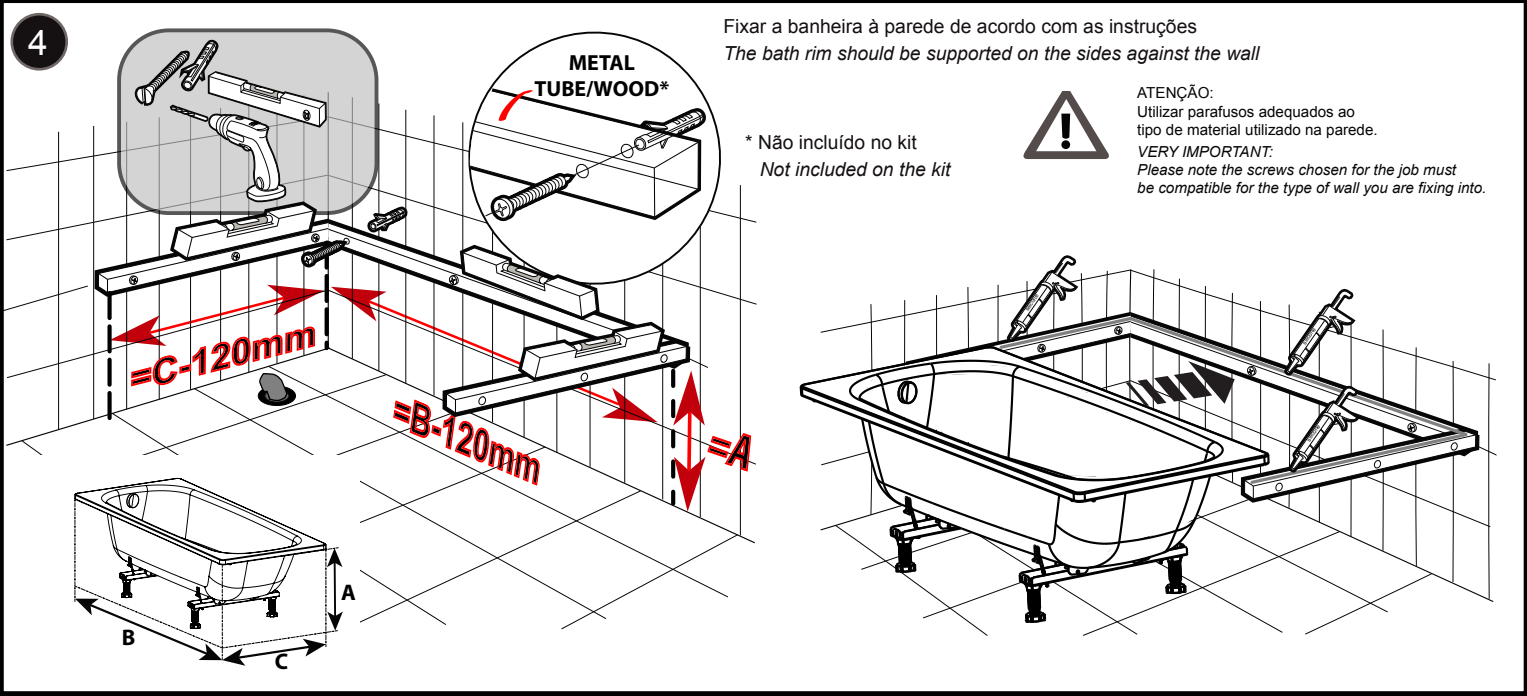
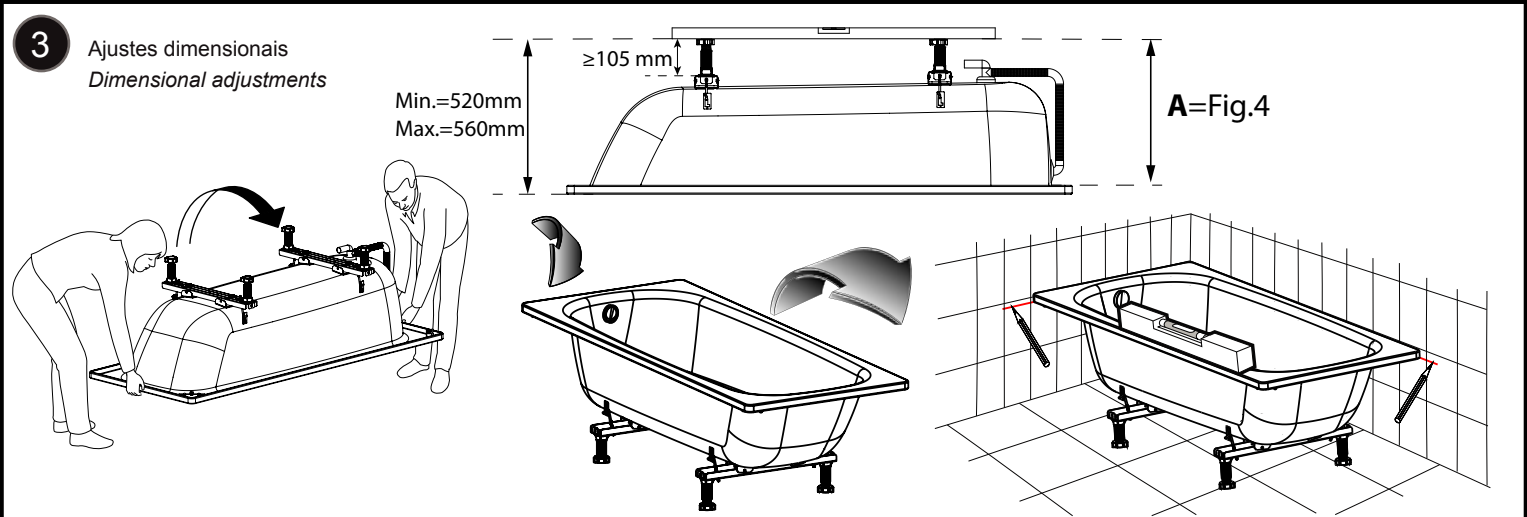
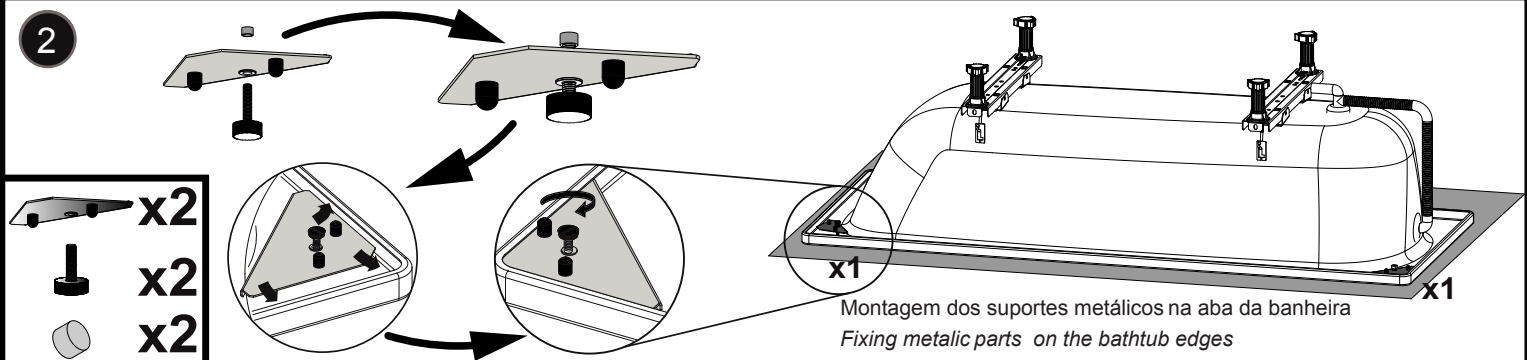
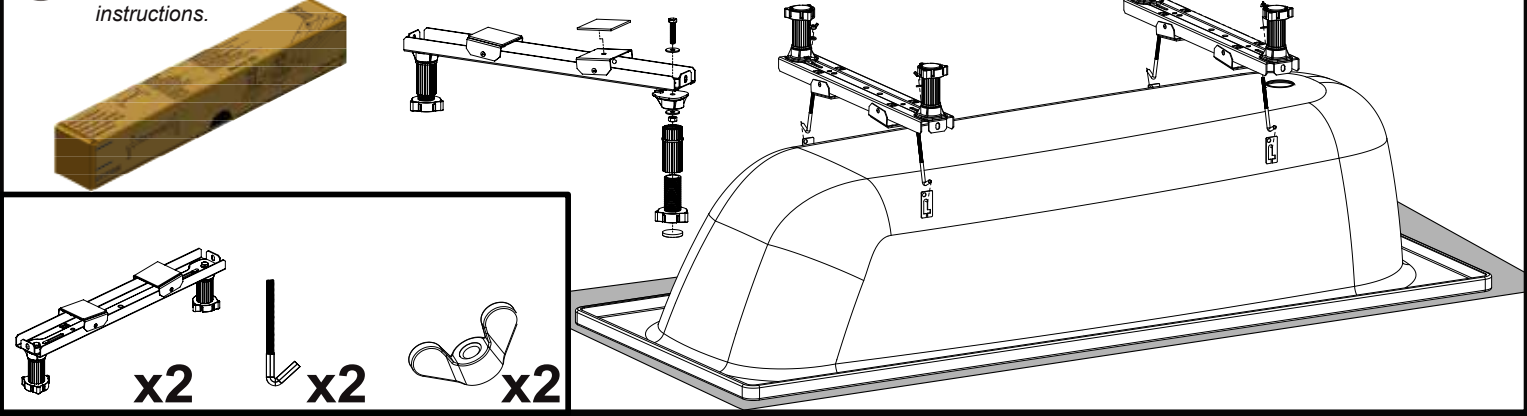

5



Montar as ligações de esgoto no local destinado
Connect the bathtub drain and overflow fittings
to the local sewerage

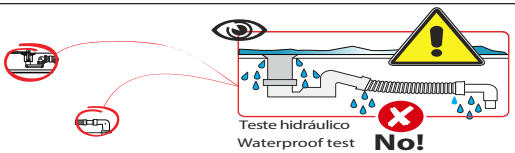
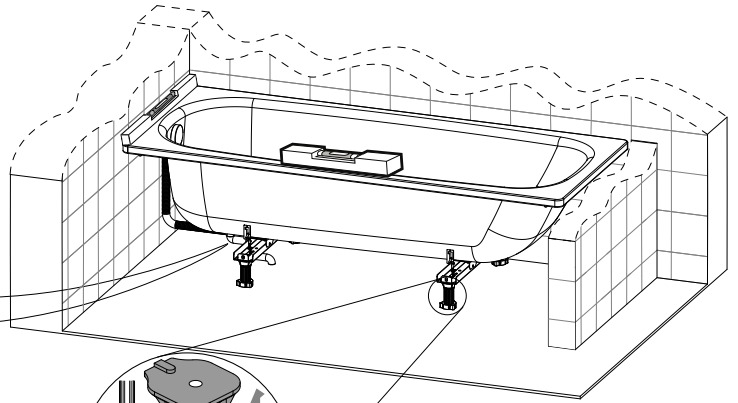
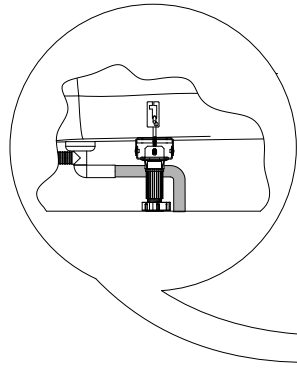
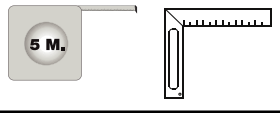

Não incluído no kit
Not included on the kit

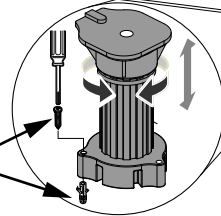

6

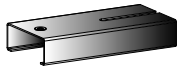
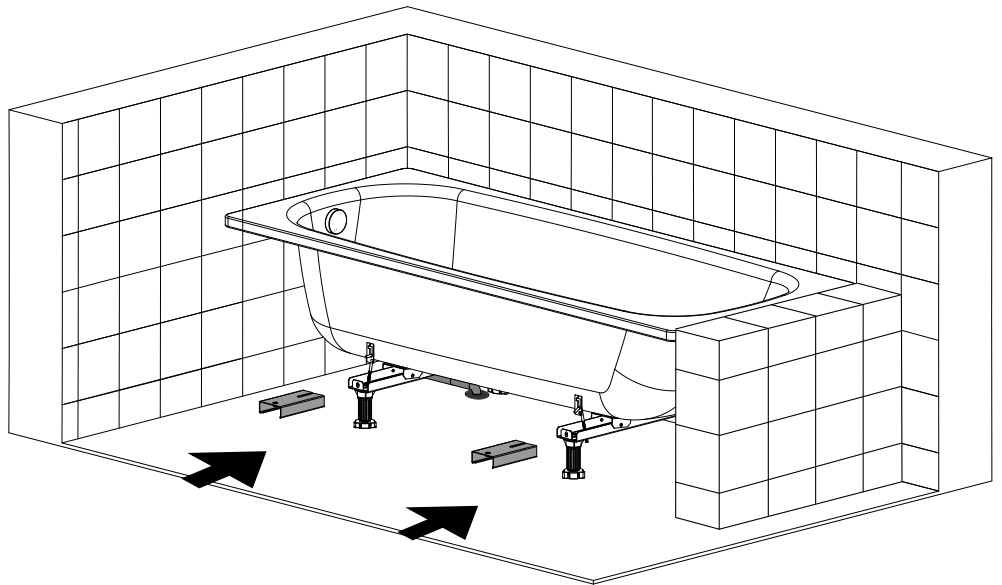

x2

7

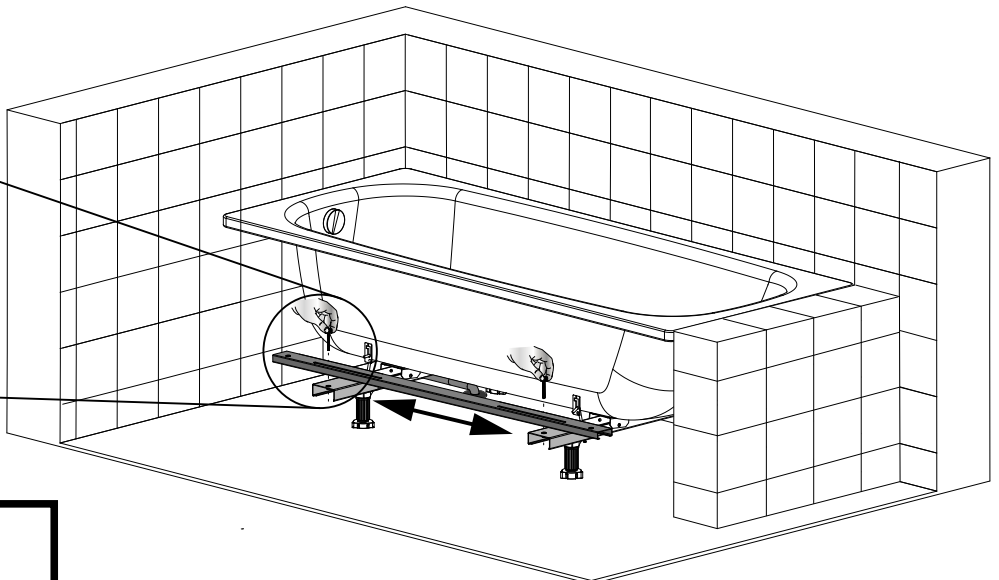
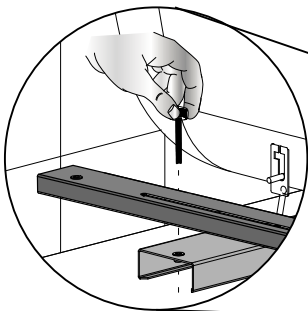

x1



x2

8

Parafuso e cone de aperto do painel
Screw and fastening cone of panel

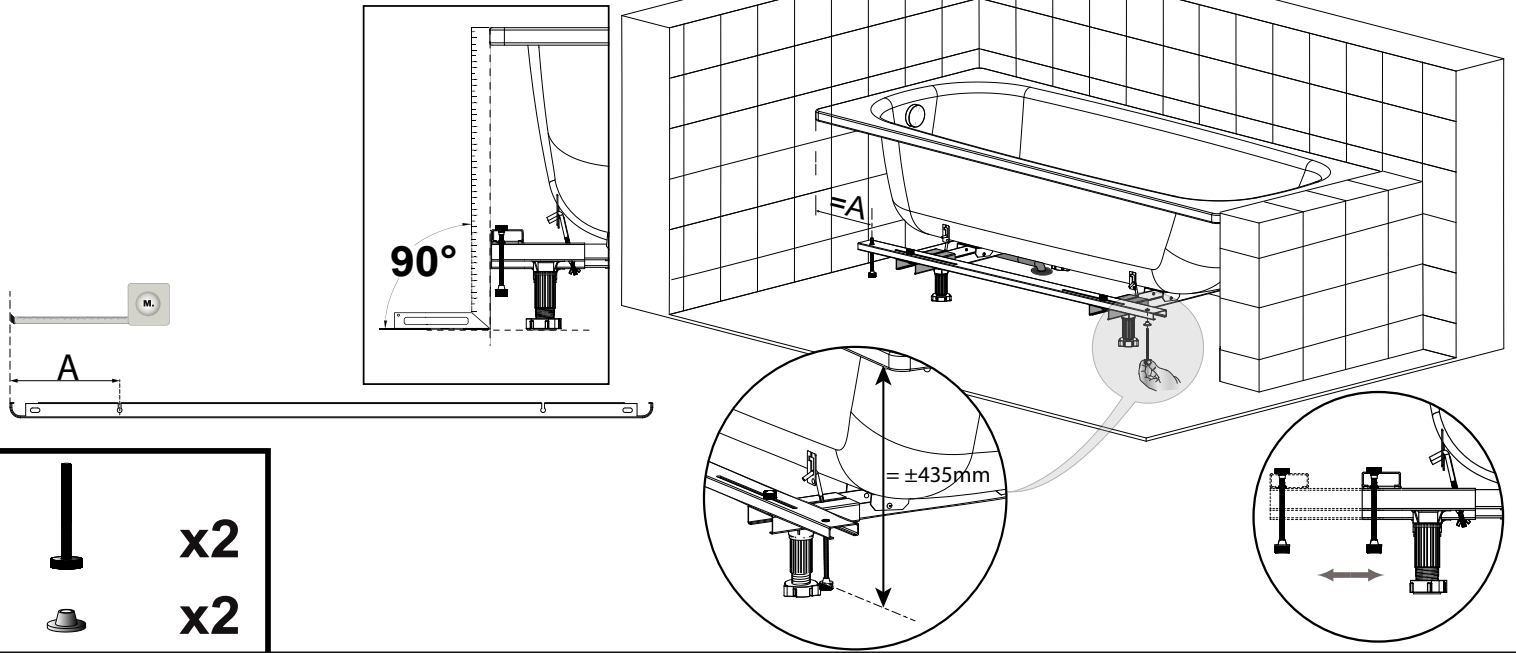

9

Colocação e ajuste do painel frontal
Front panel assembly

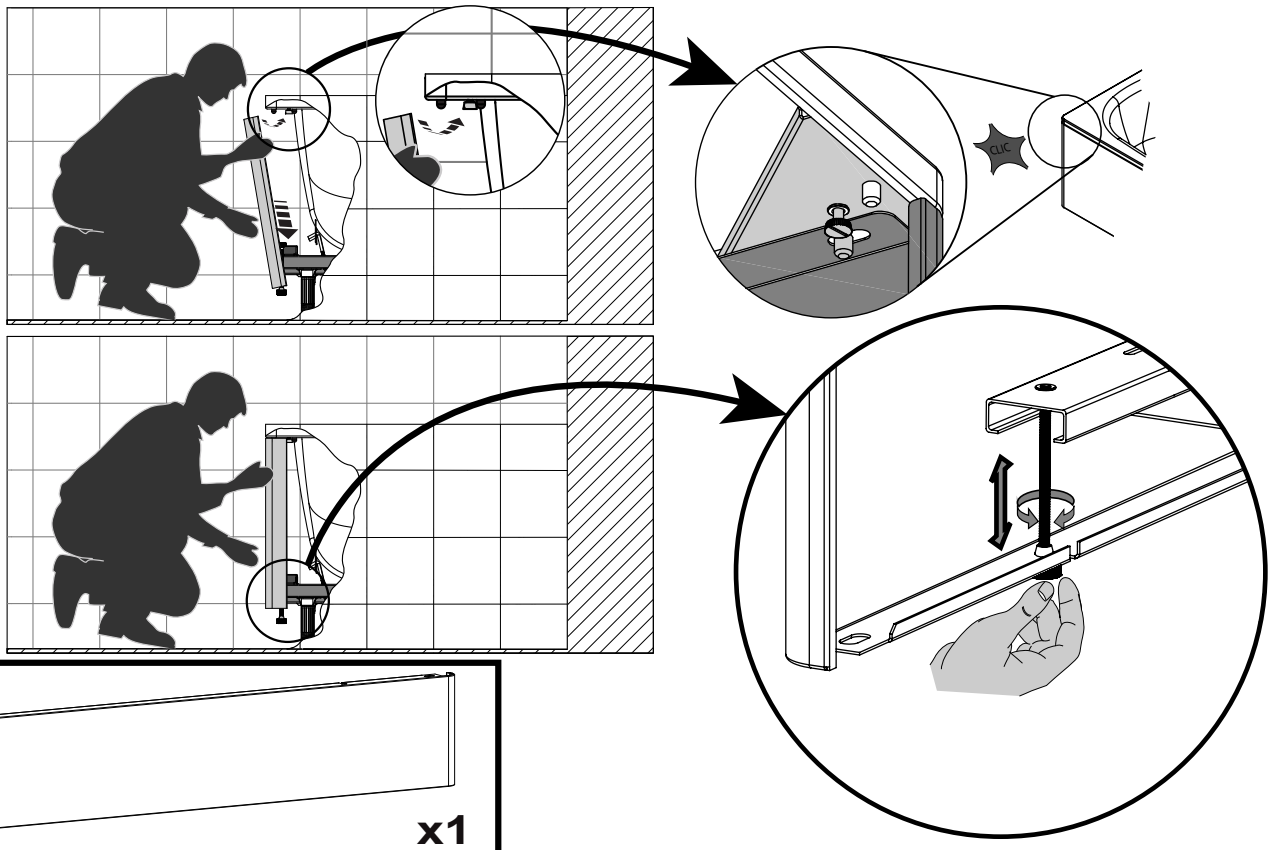

10

Inspeção e verificação
Inspection and verification

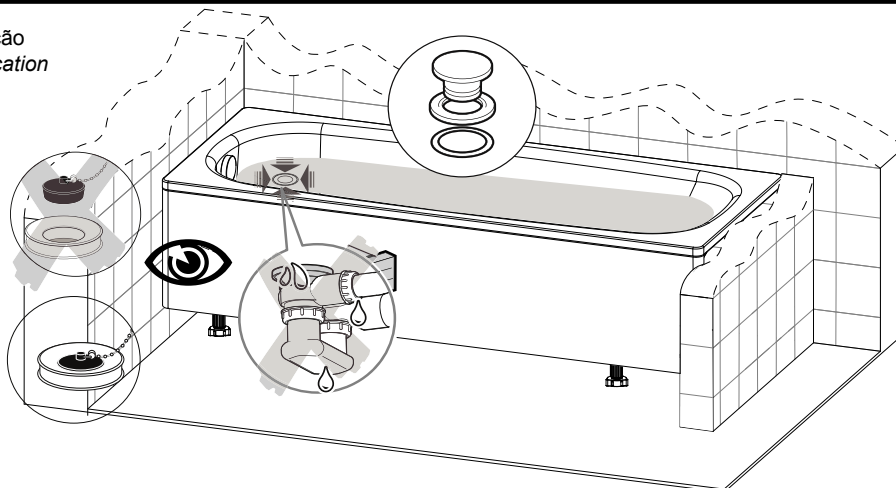

LAUFEN

Laufen Bathrooms AG
Wahlenstrasse 46
CH-4242 Laufen, Switzerland
www.laufen.com

LAUFEN QUALITY CONTROL

Controller's Name: _____

Fabrication-No.: _____

Date: _____



Laufen Bathrooms AG
EN 14516

Postfach 432

CH-4242 Laufen